

REASSEMBLY

CAUTION:

Wear protective gloves. Sharp surfaces on the front seat adjuster could cause injuries to your hands.

1. INSTALL FRONT SEAT WIRE (for Front Passenger Side)

- (a) Install the seat wire with the 4 clamps.
- (b) Engage the claw and install the connector.
- (c) Connect the 4 connectors.

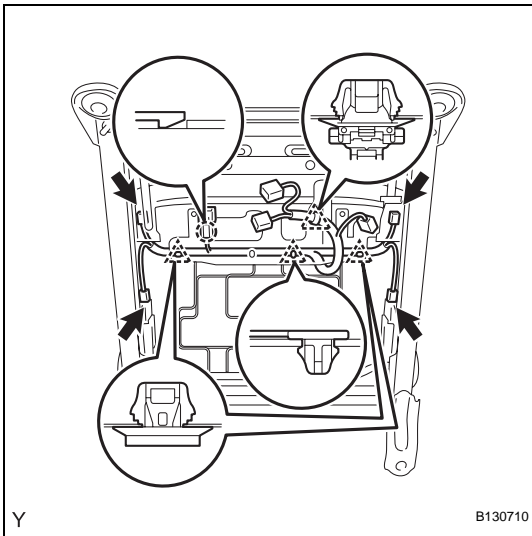

2. INSTALL OCCUPANT CLASSIFICATION ECU (for Front Passenger Side)

- (a) Engage the claw and install the occupant classification ECU.
- (b) Connect the 2 connectors.

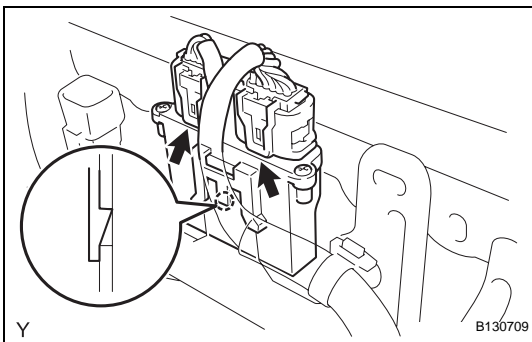

3. INSTALL SEAT POSITION SENSOR (for Driver Side)

- (a) Install the seat position sensor with the bolt.
Torque: 8.0 N*m (80 kgf*cm, 71 in.*lbf)

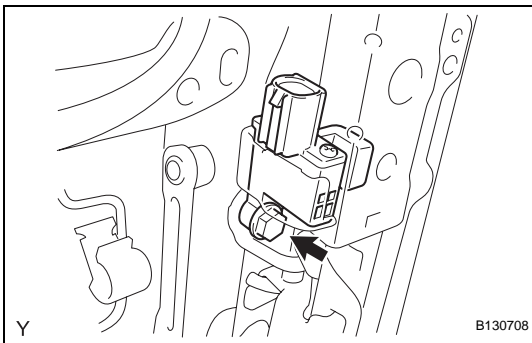

4. INSTALL FRONT SEAT CUSHION EDGE PROTECTOR

- (a) Install the 2 front seat cushion edge protectors.

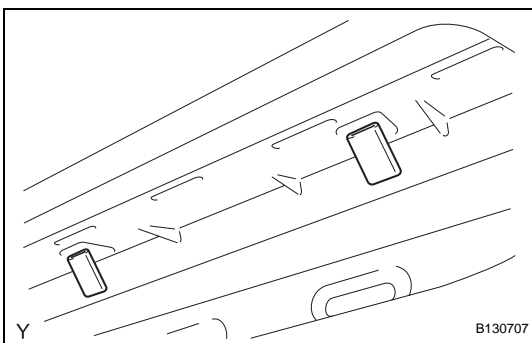

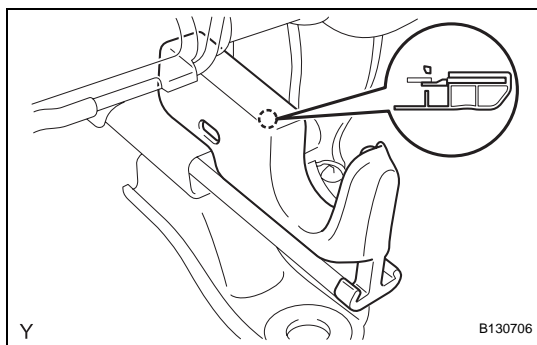

5. INSTALL FRONT SEAT CUSHION LOWER SHIELD RH

- (a) Engage the claw and install the front seat cushion lower shield.

6. INSTALL FRONT SEAT CUSHION LOWER SHIELD LH
HINT:

Use the same procedure as for the RH side.

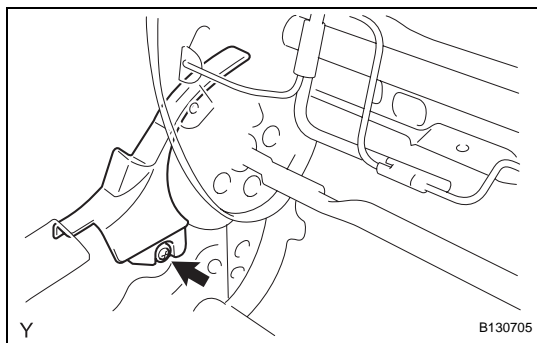

7. INSTALL RECLINING ADJUSTER OUTSIDE COVER RH

- (a) Install the reclining adjuster outside cover with the screw.

8. INSTALL RECLINING ADJUSTER OUTSIDE COVER LH
HINT:

Use the same procedure as for the RH side.

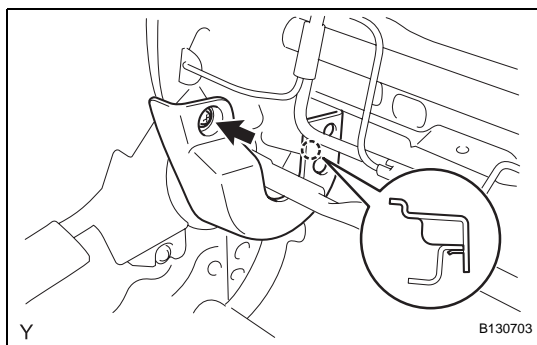

9. INSTALL RECLINING ADJUSTER INSIDE COVER RH

- (a) Engage the claw and install the reclining adjuster inside cover.
(b) Tighten the screw.

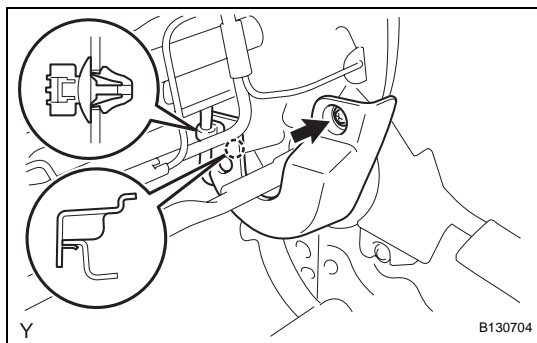

10. INSTALL RECLINING ADJUSTER INSIDE COVER LH

- (a) Engage the claw and install the reclining adjuster inside cover.
(b) w/ Front Seat Side Airbag:
(1) Install the clamp.
(c) Tighten the screw.

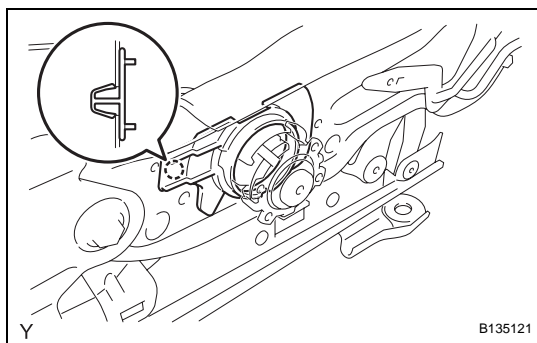

11. INSTALL VERTICAL SEAT ADJUSTER BUSH (for Driver Side)

- (a) Engage the claw and install the vertical seat adjuster bush.

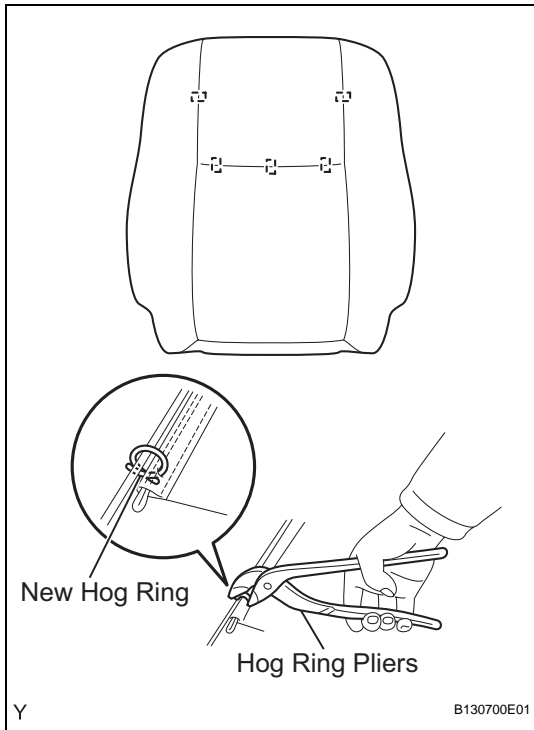

12. INSTALL FRONT SEATBACK COVER

- (a) Using hog ring pliers, install the front seatback cover with 5 new hog rings.

NOTICE:

- Do not soil or scratch the front seatback cover.
- When installing the hog rings, minimize wrinkles as far as possible.

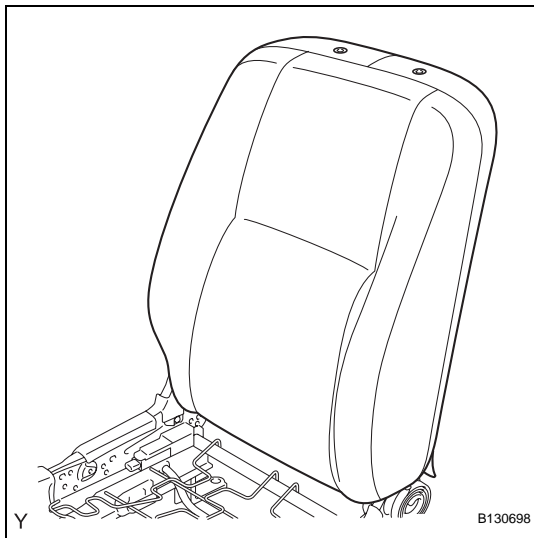

13. INSTALL FRONT SEATBACK ASSEMBLY

- (a) Install the front seatback.

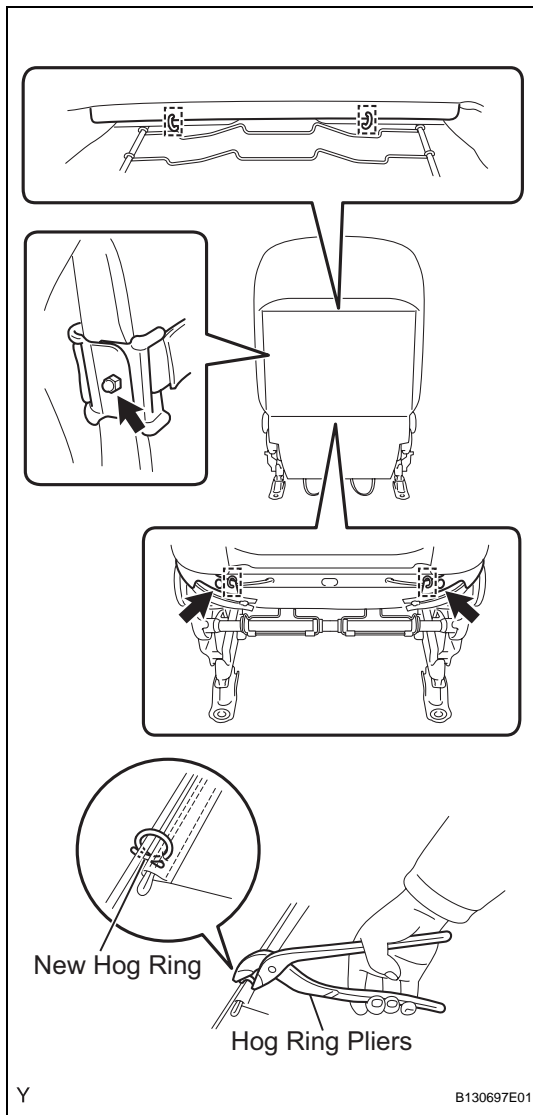

(b) w/ Front Seat Side Airbag:

(1) Fully cover the airbag with the 2 front seatback cover brackets and tighten the nut.

Torque: 5.5 N*m (55 kgf*cm, 49 in.*lbf)

CAUTION:

- For vehicles with front seat side airbag, the front seatback cover must be securely installed. Otherwise, the front seat side airbag may not deploy properly.
- Make sure that the strap is not twisted after installing the bracket.
- Install the bracket securely.

(c) Using hog ring pliers, install 4 new hog rings.

(d) Install the 2 clips.

- (e) Fasten the 2 zippers.
- (f) Using hog ring pliers, install 2 new hog rings.

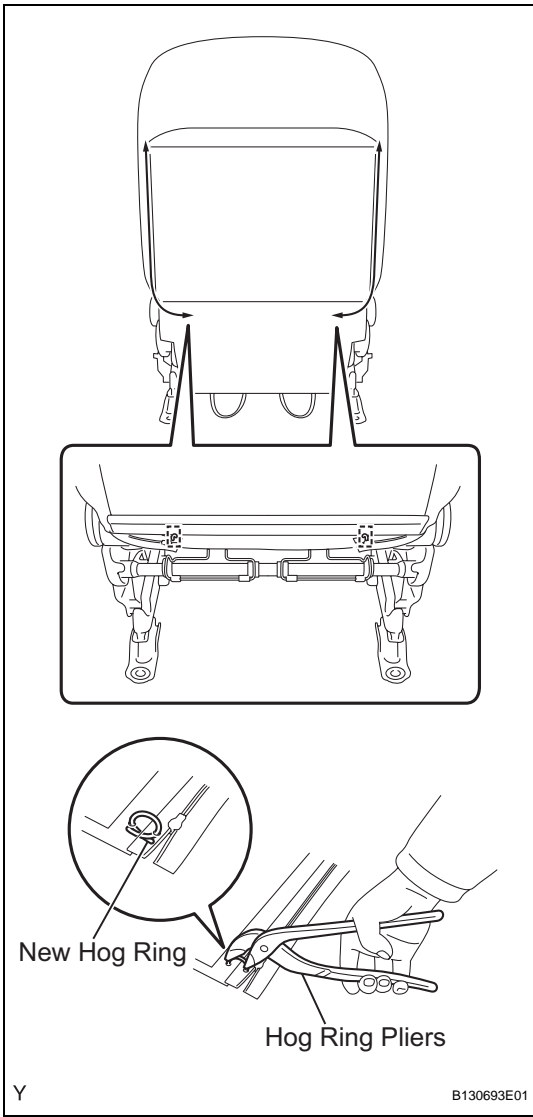

- (g) Using hog ring pliers, install 3 new hog rings.

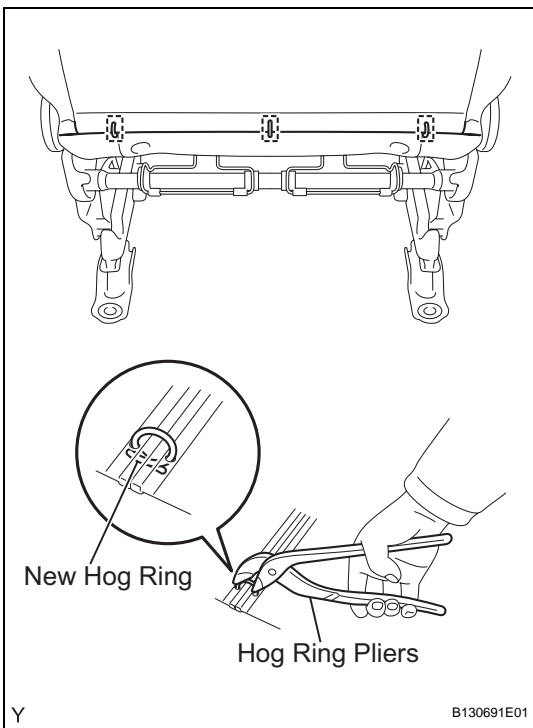

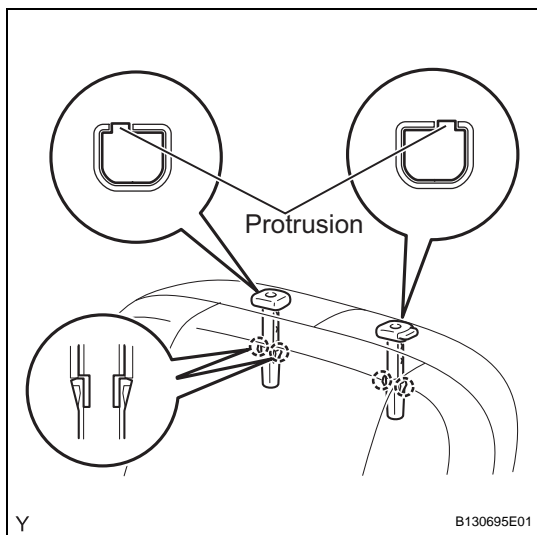
**14. INSTALL FRONT SEAT HEADREST SUPPORT****HINT:**

Use the same procedure for both sides.

- (a) Align the protruding portion of the front seat headrest support with the installation groove of the front seatback frame.
- (b) Engage the 2 claws and install the front seat headrest support.

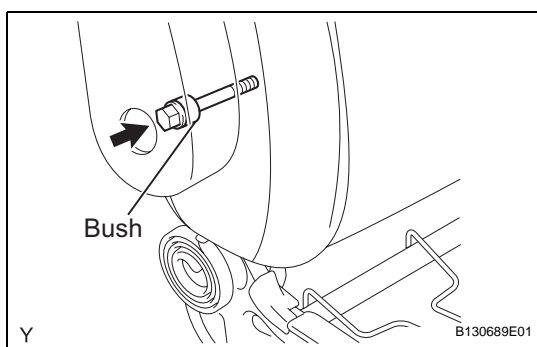
**15. INSTALL FRONT SEAT ARMREST ASSEMBLY (for Driver Side)**

- (a) Install the bush onto the front seat armrest.
 - (b) Install the front seat armrest with the bolt.
- Torque: 38 N*m (385 kgf*cm, 28 ft.*lbf)**

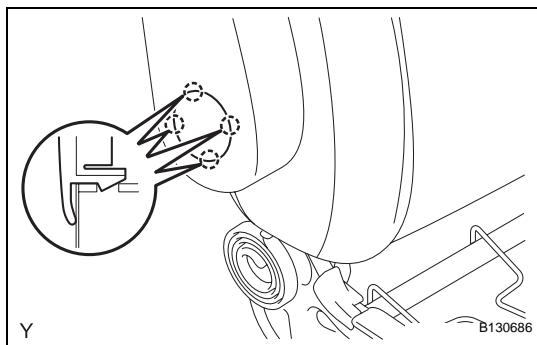
**16. INSTALL FRONT SEAT ARMREST CAP (for Driver Side)**

- (a) Engage the 4 claws and install the front seat armrest cap.

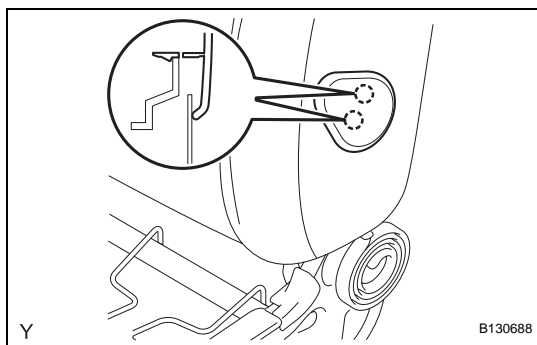
**17. INSTALL FRONT SEAT ARMREST COVER (for Front Passenger Side)**

- (a) Engage the 2 claws and install the front seat armrest cover.

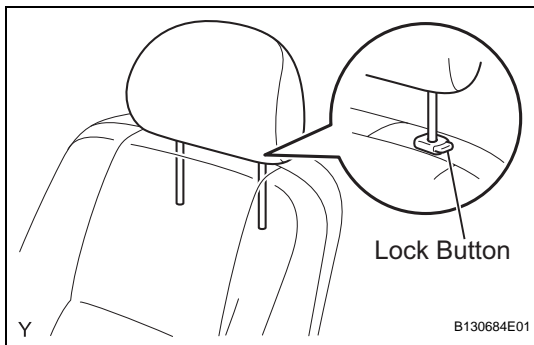

18. INSTALL FRONT SEAT HEADREST ASSEMBLY

- (a) Push in the lock button of the front seat headrest support and install the front seat headrest.

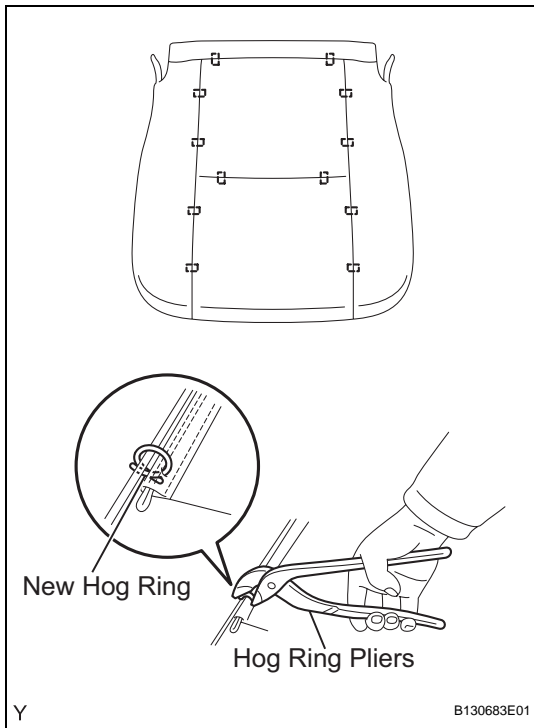

19. INSTALL FRONT SEAT CUSHION COVER

- (a) Using hog ring pliers, install the front seat cushion cover with 12 new hog rings.

NOTICE:

- Do not soil or scratch the front seat cushion cover.
- When installing the hog rings, minimize wrinkles as far as possible.

20. INSTALL FRONT SEAT CUSHION ASSEMBLY

- (a) Engage the 2 claws and the 7 hooks and install the front seat cushion.

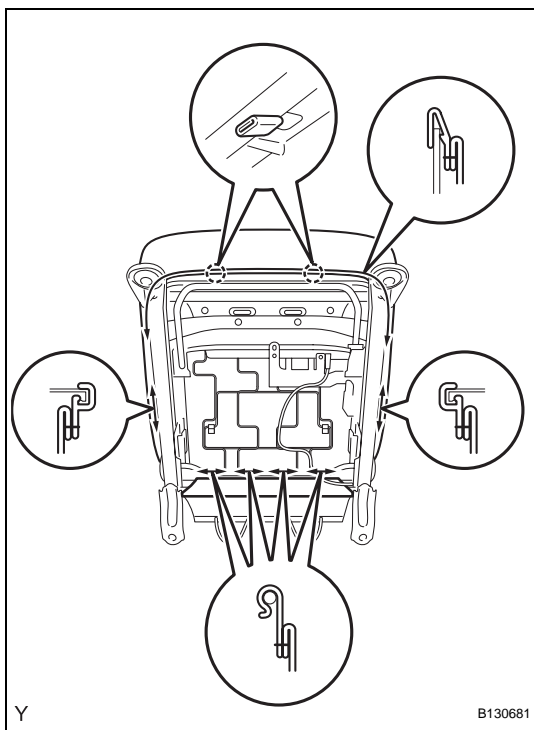

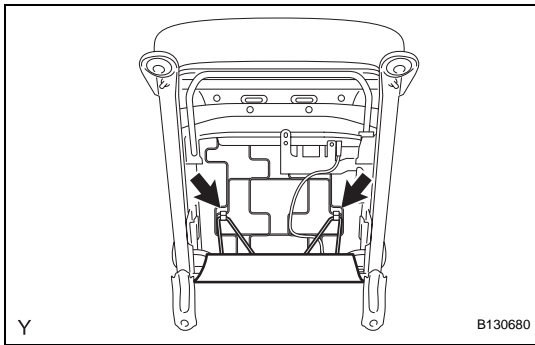

(b) Install the 2 front seatback cover bands.

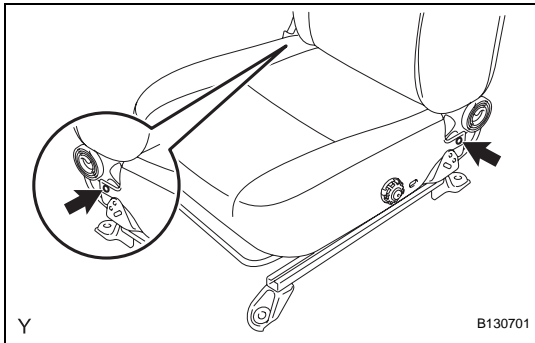

(c) Install the 2 clips.

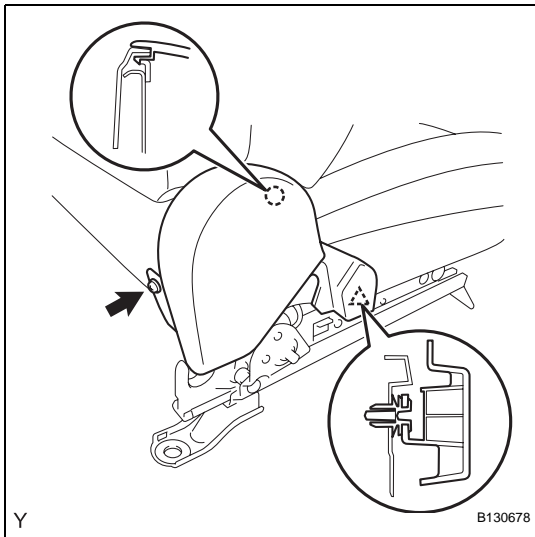

21. INSTALL FRONT SEAT CUSHION INNER SHIELD

- (a) Engage the claw and the clip and install the front seat cushion inner shield.
- (b) Tighten the screw.

22. INSTALL FRONT SEAT INNER BELT ASSEMBLY (See page [SB-32](#))

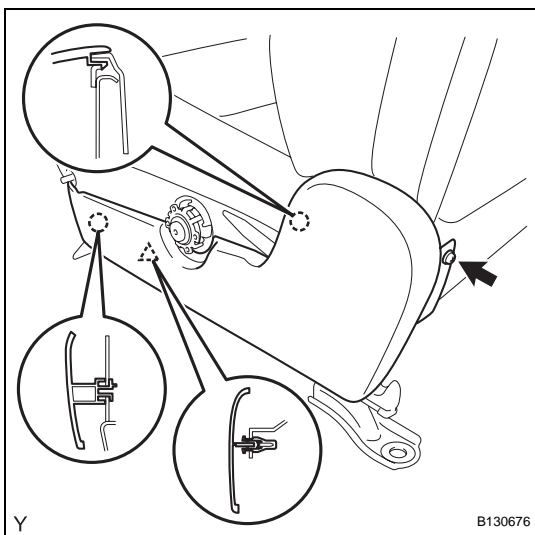

23. INSTALL FRONT SEAT CUSHION OUTSIDE SHIELD

- (a) Engage the 2 claws and the clip and install the front seat cushion outside shield.
- (b) Tighten the screw.

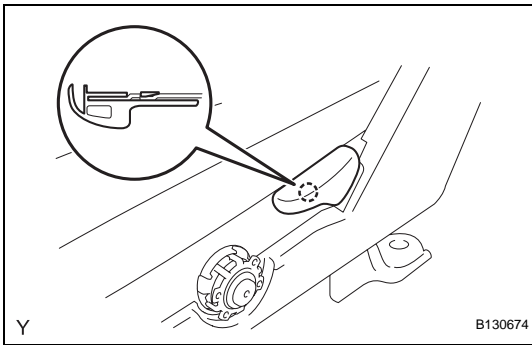
**24. INSTALL RECLINING ADJUSTER RELEASE HANDLE**

- (a) Engage the claw and install the reclining adjuster release handle.

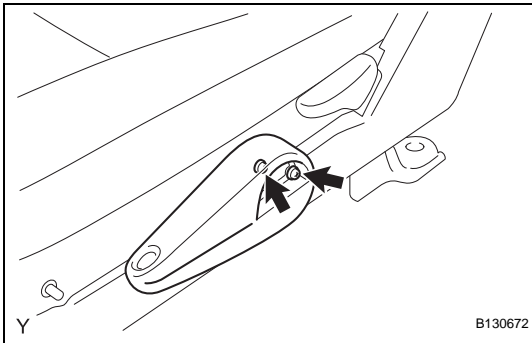
**25. INSTALL VERTICAL SEAT ADJUSTER HANDLE (for Driver Side)**

- (a) Install the vertical seat adjuster handle with the 2 screws.

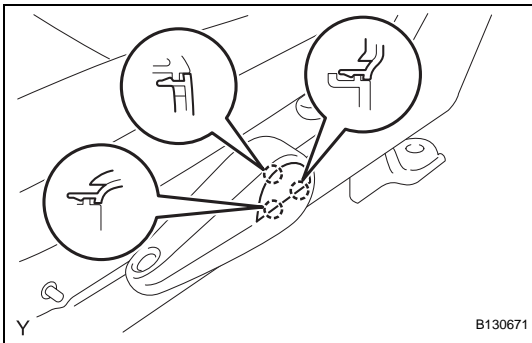
**26. INSTALL VERTICAL SEAT ADJUSTER HANDLE COVER (for Driver Side)**

- (a) Engage the 3 claws and install the vertical seat adjuster handle cover.

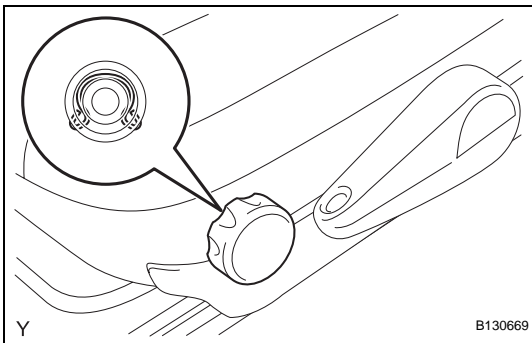
**27. INSTALL VERTICAL SEAT ADJUSTER KNOB (for Driver Side)**

- (a) Engage the snap ring and install the vertical seat adjuster knob.